

NOTE:
 MATERIAL:
 HOUSING: THERMOPLASTIC(NYLON+GF)
 CONTACT: BRASS
 PLATING:
 CONTACT: GOLD PLATING
 SPECIFICATION:
 VOLTAGE RATING: 50V
 CURRENT RATING: 1.1A
 CONTACT RESISTANCE TERMINAL: 20mΩ MAX
 DIELECTRIC WITHSTANDING VOLTAGE: 500V AC
 INSULATION RESISTANCE: 1000MΩ MIN
 PART NO.:

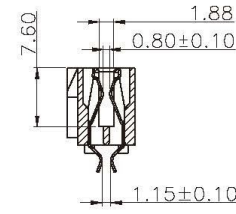

SECTION: A-A

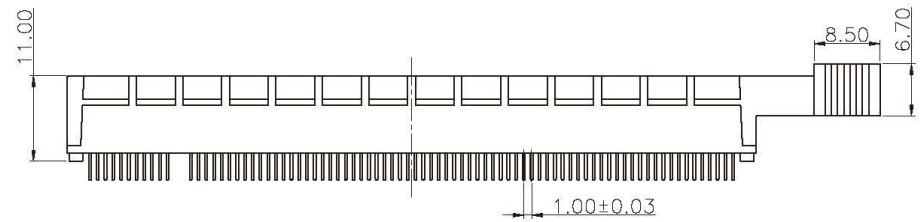
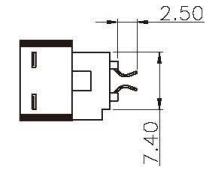
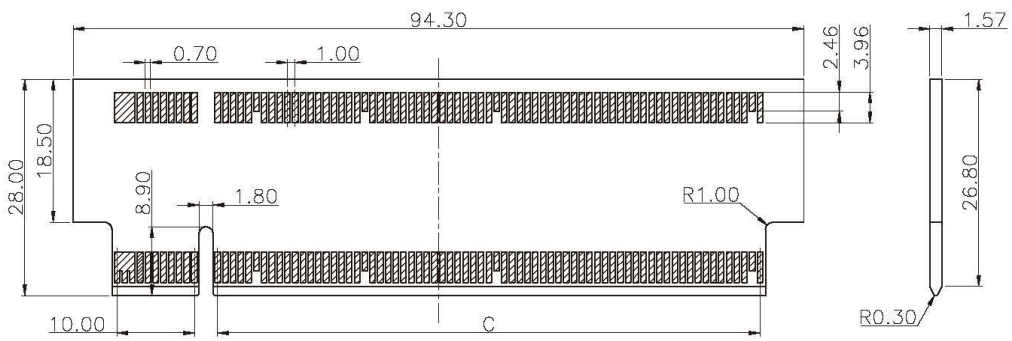

RECOMMENDED MODULE LAYOUT

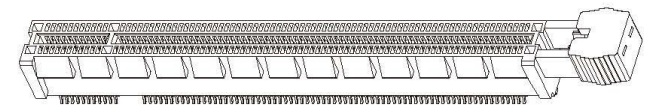

All Connectors
 www.allconnectors.de info@allconnectors.de
 Tel.: 0049 711 7009503 Fax: 0049 711 7009504
 70794 Filderstadt - Germany Kettenerstr. 25

RoHS Compliant		TOLERANCES ARE
DRAWING BY CY		X ±
CHECKED BY GENIUS		.X ±
UNIT/ mm	SCALE 1 : 1	.XX ±
DATE		.XXX ±
SIZE A4	PJECTION	ANG ±

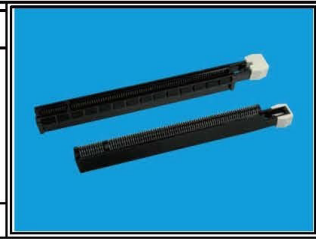

ORDER INFORMATION

PCIX-ELF-164-LF

- SERIES
- EDGE CLIP
- FLANGE LOCK
- 164WAY
- LEADFREE

DESCRIPTION: PCI 1.0 164P 推拉夾板式成品